Kodak EasyShare C763 zoom digital camera



User's guide

www.kodak.com

For interactive tutorials, www.kodak.com/go/howto

For help with your camera, www.kodak.com/go/c763support

Kodak

Eastman Kodak Company

Rochester, New York 14650

© Eastman Kodak Company, 2007

All screen images are simulated.

Kodak and EasyShare are trademarks of Eastman Kodak Company.

P/N 4J6157_en

Front view



- 1 Shutter button
- 2 On/Off button
- 3 Flash
- 4 Self-timer/Video light
- 5 Lens
- 6 USB
- 7 Microphone
- 8 Zoom lever

Back view

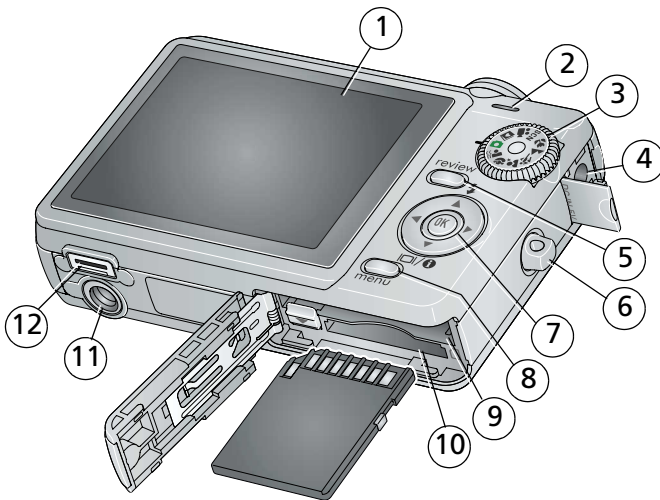



- 1 LCD
- 2 Speaker
- 3 Mode dial
- 4 DC-In (5V)  for AC adapter
- 5 Review button
- 6 Strap post
- 7 
 - ▲ Flash (in Capture modes)
 - ▲ Multi-up (in Review mode)
 - ▼ Display/InfoOK button
- 8 Menu button
- 9 Slot for optional SD or MMC card
- 10 Battery compartment
- 11 Tripod socket
- 12 Dock connector

Table of contents

1	Setting up your camera	1
	Attaching the strap	1
	Charging the KLIC-7005 battery	1
	Loading the KLIC-7005 battery	2
	Turning on the camera	2
	Setting the language and date/time	3
	Storing pictures on an SD or MMC card	4
2	Taking pictures/videos	5
	Taking a picture	5
	Using zoom lever	7
	Using the mode dial	8
	Using the flash button	10
	Understanding picture-taking icons	11
3	Reviewing pictures/videos	12
	Using the review button	12
	Deleting pictures/videos	13
	Cropping pictures	14
	Running a slide show	14
	Viewing as thumbnails (multi-up)	16
	Sharing your pictures/videos	16
	Tagging pictures/videos for albums	21
	Copying pictures/videos	23
	Viewing picture/video information	24
4	Doing more with your camera	26
	Using the menu button	26
	Using the setup menu	29
	Using exposure compensation to adjust brightness	31
	Using burst	32

5	Transferring and printing pictures	33
	Installing the software	33
	Transferring pictures with the USB cable	34
	Printing pictures	35
	Dock compatibility for your camera	37
6	Troubleshooting	38
7	Getting help	41
8	Appendix	43
	Camera specifications	43
	Care and maintenance	46
	Important safety instructions	46
	Upgrading your software and firmware	47
	Storage capacities	47
	Battery life	48
	Limited warranty	48
	Regulatory compliance	50

1

Setting up your camera

Attaching the strap

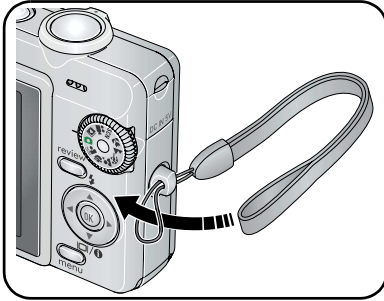

Charging the KLIC-7005 battery

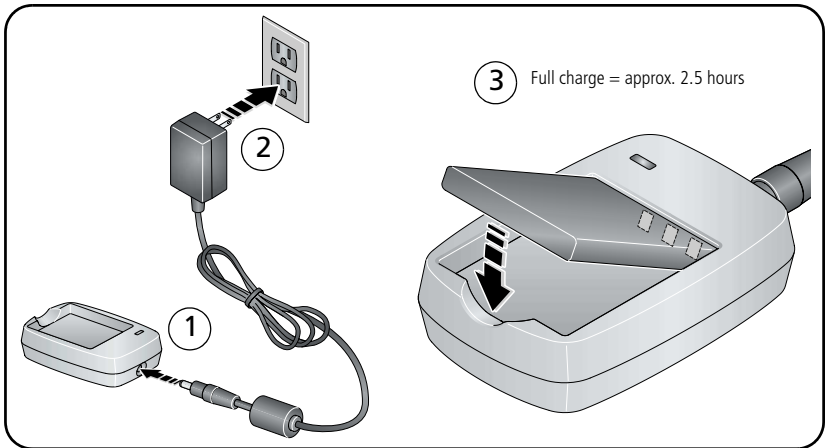

Loading the KLIC-7005 battery

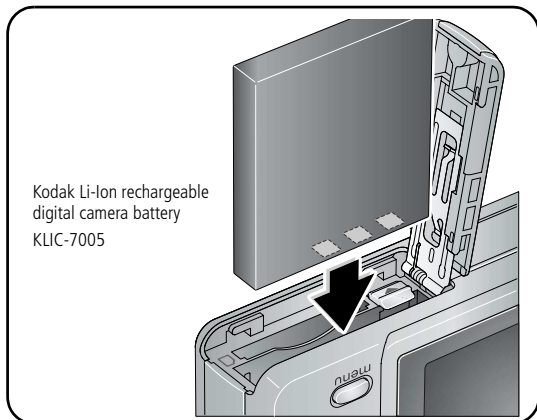

To extend battery life, see [page 48](#).

Turning on the camera

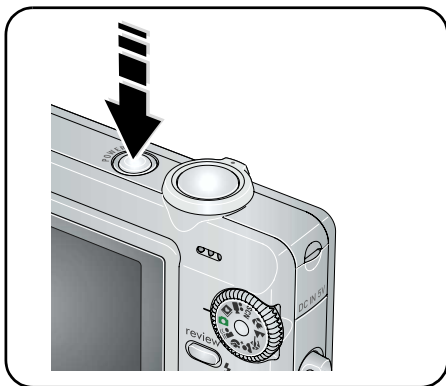

Setting the language and date/time

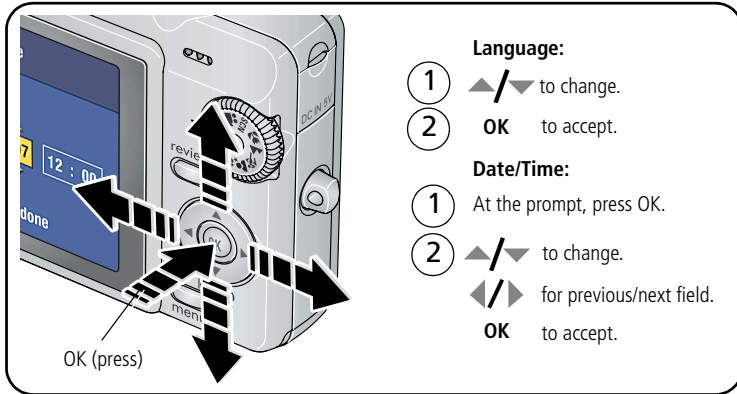

NOTE: To change language or date/time in the future, [page 29](#).

Storing pictures on an SD or MMC card

Your camera has internal memory. You can purchase an SD or MMC card to conveniently store more pictures/videos.

NOTE: When using the card for the first time, format it in this camera before taking pictures (see [page 29](#)). We recommend Kodak SD or MMC cards.

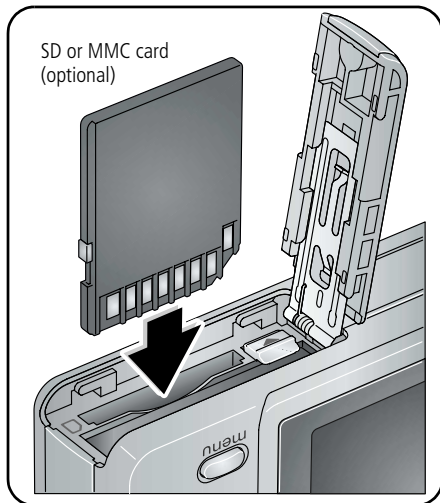

CAUTION:

A card can only be inserted one way; forcing it may cause damage. Inserting or removing a card while it is being accessed by the camera may damage the pictures, the card, or the camera.

Purchase SD or MMC cards at a dealer of Kodak products or at www.kodak.com/go/c763accessories.

2 Taking pictures/videos

Taking a picture

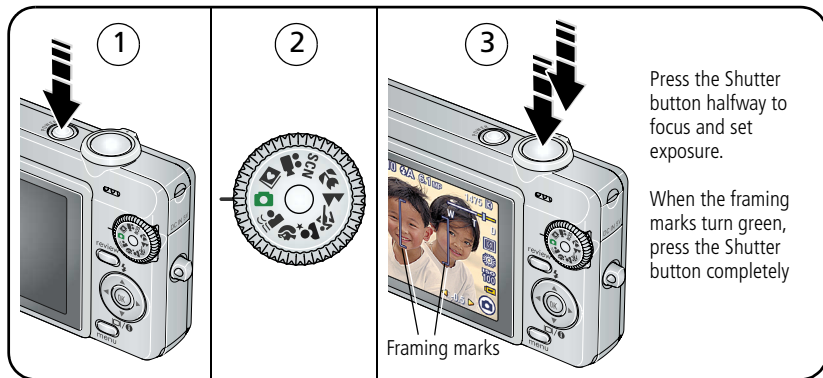

Taking a video

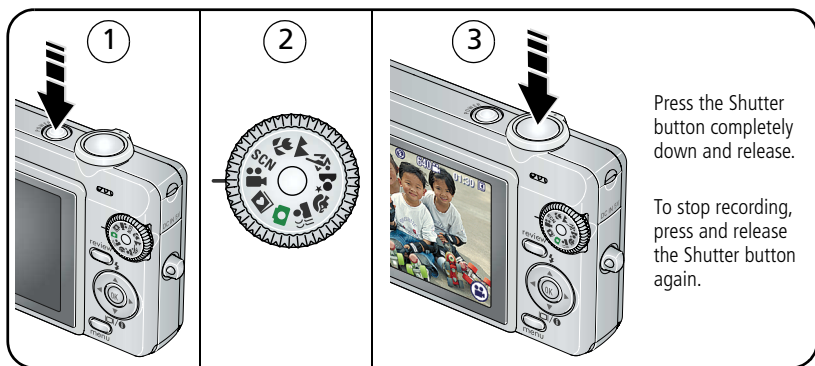

Reviewing the picture/video just taken

After you take a picture/video, the LCD displays a quickview for approximately 5 seconds.

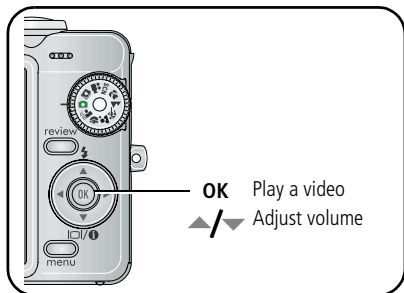

To review pictures/videos anytime, see [page 12](#).

Using the auto-focus framing marks (to take pictures)

Framing marks indicate the camera focus area. The camera attempts to focus on foreground subjects, even if the subjects are not centered in the scene.

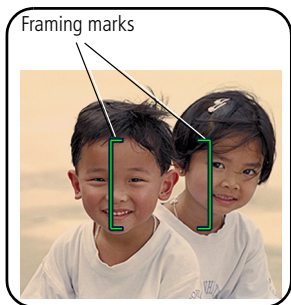

- 1 Press the Shutter button **halfway**.
When the framing marks turn green, focus is accomplished.
- 2 If the camera is not focusing on the desired subject (or if the framing marks disappear), release the Shutter button and recompose the scene.
- 3 Press the Shutter button **completely down** to take the picture.

NOTE: Framing marks do not appear in Landscape, Fireworks, or Video mode. When you use Focus Zone (see [page 26](#)) and set Center Zone, the framing marks are fixed at Center Wide.

Using zoom lever

Use optical zoom to get up to 3X closer to your subject.

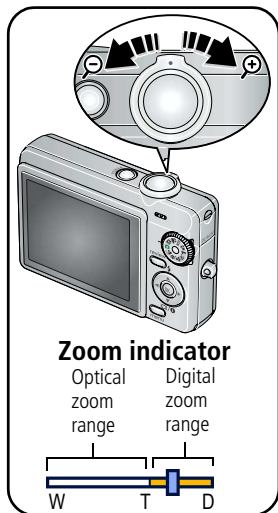

- 1 Press the Zoom lever to zoom in or out.

The zoom indicator shows zoom status.

- 2 Take the picture/video.

NOTE: For focus ranges, [see page 43](#).

Using digital zoom

Use digital zoom in any Still mode to get up to 15X magnification.









- 1 Press the Zoom lever to the optical zoom limit (3X). Release the lever, then press it again.
- 2 Take the picture/video.

NOTE: You cannot use digital zoom for video recording. You may notice decreased image quality when using digital zoom. The blue slider on the zoom indicator pauses and turns red when the picture quality reaches the limit for an acceptable 4 x 6-in. (10 x 15 cm) print.

Using the mode dial



Choose the mode that best suits your subjects and surroundings.

Use this mode	For
 AUTO	General picture taking—offers an excellent balance of image quality and ease of use.
 Digital Image Stabilization	Reducing blur caused by camera shake or subject motion.
 Portrait	Full-frame portraits of people. Subject is sharp and the background is indistinct.
 Night Portrait	Reduces red eye of people in night scenes or low-light conditions.
 Sports	Subjects that are in motion. Shutter speed is fast. The camera pre-settings are Multi-Pattern Exposure Metering, Multi-Zone Focus.
 Landscape	Far-away scenes. The camera uses infinity auto-focus. Auto-focus framing marks are not available in Landscape.
 Close-up	Close range. Use available light instead of flash if possible. The camera automatically sets the focus distance depending on the zoom position.
SCN Scene	Point-and-shoot simplicity when taking pictures under special conditions. (See page 9 .)
 Video	Capturing video with sound. (See page 5 .)
 Favorites	Viewing favorite pictures. (See page 19 .)

Scene modes

- 1 Turn the Mode dial to Scene **SCN**.
- 2 Press ◀/▶ to display Scene mode descriptions.

NOTE: If the Scene mode description turns off, press OK.

- 3 Press OK to choose a Scene mode.

Use this SCN mode	For
Children	Action pictures of children in bright light.
Party	People indoors. Minimizes red eye.
Beach	Bright beach scenes.
Snow	Bright snow scenes.
Fireworks	Flash does not fire. Place the camera on a flat, steady surface or use a tripod.
Self-portrait	Pictures of yourself.
Backlight	Subjects that are in shadow or "backlit" (when light is behind the subject).

Using the flash button

Use the flash when you take pictures at night, indoors, or outdoors in heavy shadows.

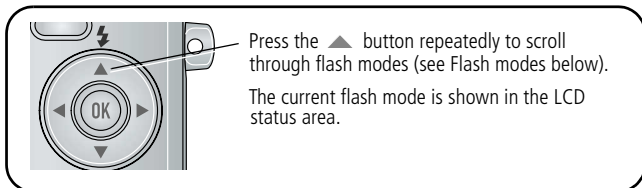

Flash modes	Flash fires	
Auto Flash	When the lighting conditions require it.	
Fill	Every time you take a picture, regardless of the lighting conditions. Use when the subject is in shadow or is "backlit" (when the light is behind the subject). In low light, hold the camera steady or use a tripod.	
Red-eye	If the Red-eye Pre-flash feature is turned off: <ul style="list-style-type: none"> ■ The flash fires once. ■ The camera then automatically corrects red-eye in the picture. 	If the Red-eye Pre-flash feature is turned on: <ul style="list-style-type: none"> ■ The flash fires once so the eyes become accustomed to the flash, then fires again when the picture is taken.
	To turn the Red-eye Pre-flash feature on/off, see see page 30 .	
Off	Never	

For flash ranges, [see page 44](#).

Understanding picture-taking icons

In capture mode—no buttons pressed

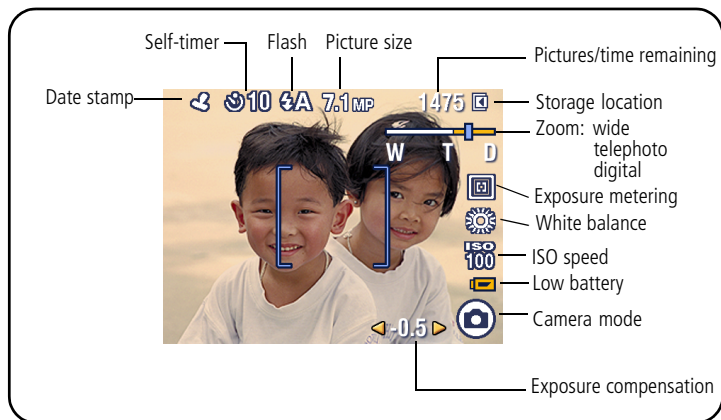

In capture mode—shutter pressed halfway

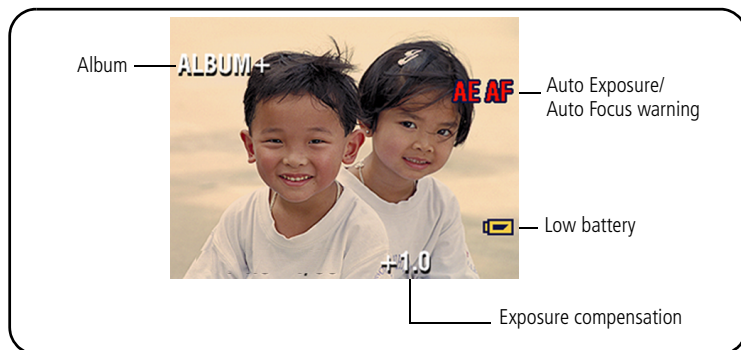

3

Reviewing pictures/videos

Using the review button



- 1 Press the Review button.
- 2 Press ◀/▶ for previous/next picture/video.

Magnifying a picture

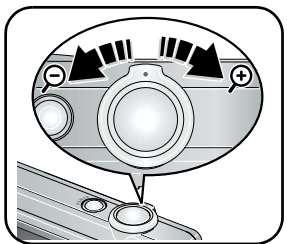

- 1 Press the Zoom lever to magnify 1X–8X.
- 2 Press ▲/▼ ◀/▶ to view other parts of a picture.
- 3 Press OK to return to 1X.

Playing a video

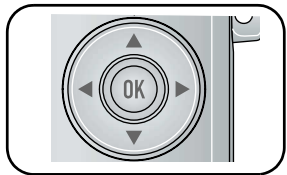

Press OK to play/pause a video.

Press ▲/▼ to adjust the volume during playback.

Deleting pictures/videos



- 1 Press Review, then press ◀/▶ for previous/next picture/video.
- 2 Press Menu.
- 3 Press ▲/▼ to highlight Delete, then press OK.
- 4 Follow the screen prompts.

Using the undo delete feature

If you accidentally delete a picture, you can use Undo Delete to retrieve it. This feature is only available immediately after you delete a picture.

Protecting pictures/videos from deletion



- 1 Press Review, then press ◀/▶ for previous/next picture/video.
- 2 Press Menu.
- 3 Press ▲/▼ to highlight Protect, then press OK.

The picture/video is protected and cannot be deleted. The Protect icon  appears with the protected picture/video.

Press the Menu button to exit the menu.

Cropping pictures

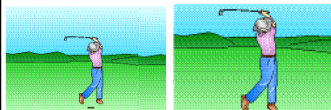

Picture

Cropped picture

- 1 Press Review.
- 2 ◀/▶ for previous/next.
- 3 Press Menu, choose Crop, then press OK.
- 4 Press the Zoom lever to zoom in, or
◀/▶ ▶/◀ to move the crop box.
- 5 Follow the screen prompts.

The picture is copied, then cropped. The original picture is saved. A cropped picture cannot be cropped again on the camera.

Press the Menu button to exit the menu.

Running a slide show

Use the Slide Show to display your pictures/videos on the LCD. To save battery power, use a Kodak 5V AC adapter. (Visit www.kodak.com/go/c763accessories.)

Starting the slide show

- 1 Press the Review button, then press the Menu button.
- 2 Press ▶/◀ to highlight Slide Show, then press OK.
- 3 Press ▶/◀ to highlight Begin Show, then press OK.

Each picture/video is displayed once.

To interrupt the Slide Show, press OK.

Changing the slide show display interval

The default interval setting displays each picture for 5 seconds. You can set the display interval from 3 to 60 seconds.

1 On the Slide Show menu, press ▲/▼ to highlight Interval, then press OK.

2 Select a display interval.

To scroll through the seconds quickly, press and hold ▲/▼.

3 Press OK.

The interval setting remains until you change it.

Running a continuous slide show loop

When you turn on Loop, the slide show is continuously repeated.

1 On the Slide Show menu, press ▲/▼ to highlight Loop, then press OK.

2 Press ▲/▼ to highlight On, then press OK.

The slide show repeats until you press OK or until battery power is exhausted. The Loop feature remains until you change it.

Viewing as thumbnails (multi-up)

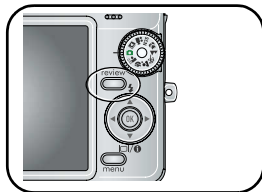

- 1 Press the Review button.
- 2 Press \blacktriangle to change from single-picture view to multi-up thumbnails.
- 3 Press OK to return to single-picture view.

Sharing your pictures/videos

Use the Share feature to tag:

- Pictures for printing
- Pictures/videos for emailing ([page 17](#))
- Pictures as favorites ([page 19](#))

Tagging pictures for printing

- 1 Press the Review button, then press $\blacktriangle/\blacktriangleright$ to locate a picture.
- 2 Press the Menu button. Press $\blacktriangle/\blacktriangleright$ to highlight Share, then press OK.
- 3 Press $\blacktriangle/\blacktriangleright$ to highlight Print, then press OK.
- 4 Press $\blacktriangle/\blacktriangleright$ to select the number of copies (0–99). Zero removes the tag for that picture.

Optional: You can apply a print quantity to other pictures. Press $\blacktriangle/\blacktriangleright$ to locate a picture. Press $\blacktriangle/\blacktriangleright$ to change the print quantity. Repeat until the desired print quantity is applied to pictures.

- 5 Press OK.

The Print icon appears in the status area.

6 Press the Menu button to exit the menu.

* To tag all pictures in the storage location, highlight Print All, press OK, then indicate the number of copies. Print All is not available in quickview. To remove print tagging for all pictures in the storage location, highlight Cancel Prints, then press OK. Cancel Prints is not available in quickview.

Printing tagged pictures

When you transfer the tagged pictures to your computer, the Kodak EasyShare software print screen opens. For details, click the Help button in EasyShare software.

For more information on printing from your computer, printer dock, PictBridge enabled printer, or card, see [page 35](#).





NOTE: For the best 4 x 6 in. (10 x 15 cm) prints, set the camera to the 6.1 MP (3:2) picture size setting (see [page 27](#)).

Tagging pictures/videos for emailing

First—on your computer

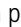
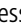
Use Kodak EasyShare software to create an email address book on your computer. Then copy up to 32 email addresses to the camera's internal memory. For details, click the Help button in EasyShare software.

Second—tag pictures/videos on your camera

- 1 Press the Review button, then press /  to locate a picture.
- 2 Press the Menu button. Press /  to highlight Share, then press OK.
- 3 Press /  to highlight Email, then press OK.

The Email icon  appears in the status area.

- 4 Press ▲/▼ to highlight an email address, then press OK.

To tag other pictures/videos with the same address, press ◀/▶ to scroll through them. When the picture you want is displayed, press OK.

To send the pictures/videos to more than one address, repeat step 4 for each address.

Selected addresses are checked.

- 5 To remove a selection, highlight a checked address and press OK. To remove all email selections, highlight Clear All.
- 6 Press ▲/▼ to highlight Exit, then press OK.
- 7 Press the Menu button to exit the menu.

Third—transfer and email

When you transfer the tagged pictures/videos to your computer, the Email screen opens and lets you send them to the addresses you specified.

Tagging pictures as favorites

You can preserve your favorite pictures in the Favorites section of your camera's internal memory, then share them with friends and family.





NOTE: When you transfer pictures from your camera to your computer, all pictures (including favorites) are stored on your computer at full size. Favorite pictures—smaller copies of your originals—are loaded back to your camera, so you can share and enjoy more.

1. Tag pictures as favorites	<ol style="list-style-type: none"> 1 Press the Review button. Press ◀/▶ to locate a picture. 2 Press the Menu button. Press ▲/▼ to highlight Share, then press OK. 3 Press ▲/▼ to highlight Favorite, then press OK. <i>The Favorite icon ♥ appears in the status area. To remove the tag, press OK again.</i> <p>Press the Menu button to exit the menu.</p>
2. Transfer pictures to your computer	<ol style="list-style-type: none"> 1 To enjoy full functionality, load and use the EasyShare software that was packaged with this camera. (See page 33.) 2 Connect the camera to the computer using the USB cable (see page 34) or an EasyShare dock. <i>The first time you transfer pictures, the software helps you make choices about your favorite pictures. Then, your pictures are transferred to the computer. Favorite pictures (smaller copies of the originals) are loaded to the Favorites section of your camera's internal memory.</i>
3. View favorites on your camera	<ol style="list-style-type: none"> 1 Turn the Mode dial to Favorites. 2 Press ◀/▶ to scroll through favorites.

NOTE: The camera holds a limited number of favorites. Use Camera Favorites in the EasyShare software to customize the size of your camera Favorites section. Videos tagged as favorites remain in the Favorites folder in EasyShare software. For details, click the Help button in EasyShare software.

Optional settings

In Favorites mode, press the Menu button to access optional settings.

	Slide Show (page 14)		Remove favorites (page 20)
	Multi-up (page 16)		Setup Menu (page 29)

NOTE: Pictures taken at the 6.1 MP (3:2) picture size setting are displayed at a 3:2 aspect ratio with a black bar at the top and bottom of the screen.

Removing favorites from your camera

- 1 Turn the Mode dial to Favorites.
- 2 Press the Menu button.
- 3 Press $\blacktriangle/\blacktriangledown$ to highlight Remove Favorites, then press OK.

All pictures stored in the Favorites section of internal memory are removed. Favorites are restored the next time you transfer pictures to the computer.

- 4 Press the Menu button to exit the menu.

Preventing camera favorites from synchronizing with the software

If you don't want to use the favorites feature:

- 1 Open EasyShare software.
- 2 From the Tools menu, select Cameras/Viewers > Sync and Transfer Manager.
- 3 Click to highlight your camera, then click Camera Favorites Album Properties.

NOTE: If your camera model is not visible, use the USB cable to connect your camera to the computer.

- 4 Drag the Internal Memory slider to 0%, then click OK.
- 5 Close the Sync and Transfer Manager window.

Camera favorites will no longer synchronize with EasyShare software.

To turn on the sync feature, select Yes, synchronize with my software.

To delete favorites from your camera, do so in Favorites mode.

Printing and emailing favorites

- 1 Turn the Mode dial to Favorites. Press ◀/▶ to locate a picture.
- 2 Press the Menu button, then ▲/▼ to highlight Share.
- 3 Highlight Print or Email, then press OK.

NOTE: Favorites that were taken on this camera (not imported from another source) are good for prints up to 4 x 6 in. (10 x 15 cm).

Tagging pictures/videos for albums

Use the Album feature in Review mode to tag the pictures/videos in your camera with album names.

First—on your computer

Use EasyShare software to create albums on your computer, then copy up to 32 album names to the camera's internal memory. See EasyShare software Help for details.

Second—on your camera

- 1 Press the Review button, then ◀/▶ to locate a picture/video.
- 2 Press the Menu button.
- 3 Press ▲/▼ to highlight Album, then press OK.
- 4 Press ▲/▼ to highlight an album folder, then press OK.

To add other pictures to the same album, press ◀/▶ to scroll through the pictures. When the picture you want is displayed, press OK.

To add the pictures to more than one album, repeat step 4 for each album.

The album name appears with the picture. A plus (+) after the album name means the picture was added to more than one album.

To remove a selection, highlight an album name and press OK. To remove all album selections, select Clear All.

Third—transfer to your computer

When you transfer the tagged pictures/videos to your computer, EasyShare software opens and categorizes your pictures/videos in the appropriate album folder. See EasyShare software Help for details.

Pre-tagging for album names

Use the Set Album (Still or Video) feature to pre-select album names before you take pictures or videos. Then, all the pictures or videos you take are tagged with those album names.

First—on your computer

Use the EasyShare software that was packaged with your camera to create album names on your computer. The next time you connect the camera to the computer, copy up to 32 albums to the album name list. See EasyShare software Help for details.

Second—on your camera

- 1 In any mode, press the Menu button.
- 2 Press $\blacktriangle/\blacktriangledown$ to highlight Set Album, then press OK.
- 3 Press $\blacktriangle/\blacktriangledown$ to highlight an album name, then press OK. Repeat to mark pictures or videos for albums.

Selected albums are noted with a check mark.

- 4 To remove a selection, highlight an album name and press OK. To remove all album selections, select Clear All.
- 5 Highlight Exit, then press OK.

Your selections are saved. Your album selection is displayed on the screen. A plus (+) after the album name means more than one album is selected.

- 6 Press the Menu button to exit the menu.

Third—transfer to your computer

When you transfer the tagged pictures or videos to your computer, EasyShare software opens and categorizes your pictures in the appropriate album.

Copying pictures/videos

You can copy pictures/videos from a card to internal memory or from internal memory to a card.

Before you copy, make sure that:

- A card is inserted in the camera.
- The camera's picture storage location is set to the location **from** which you are copying. (To set Image Storage, see [page 28](#).)

Copy pictures/videos:

- 1 Press the Review button, then press the Menu button.
- 2 Press **▲/▼** to highlight Copy, then press OK.
- 3 Press **▲/▼** to highlight an option.
- 4 Press OK.

NOTE: Pictures/videos are copied, not moved. To remove pictures/videos from the original location after copying, delete them (see [page 13](#)). Tags that you applied for print, email, and favorites are not copied. Protection settings are not copied. To apply protection to a picture/video, see [page 13](#).

Viewing picture/video information



- 1 Press Review.
- 2 Press  to turn on/off status icons and picture/video information.

Press the Review button to exit Review.

Understanding review icons

Pictures

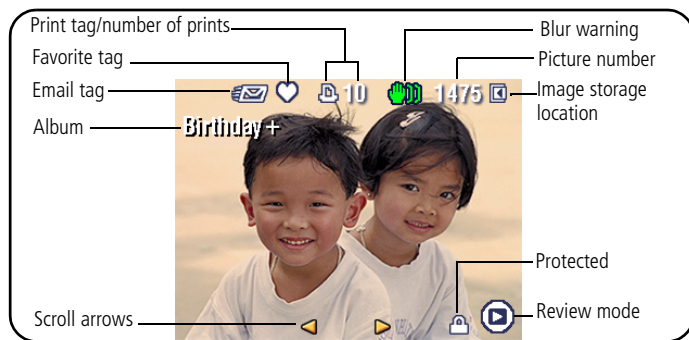

Videos

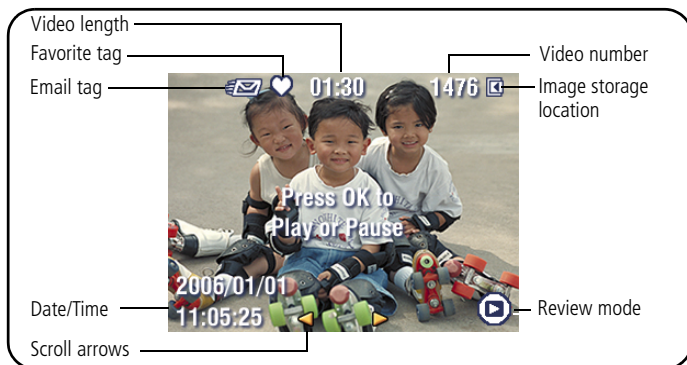

Understanding blur warning icons

If the feature is turned on (see [page 29](#)), a picture blur warning icon  is displayed during quickview and review.

Green—Picture is sharp enough for an acceptable 4 x 6-inch (10 x 15 cm) print.

Yellow—Picture may be sharp enough for an acceptable 4 x 6-inch (10 x 15 cm) print or sharpness is not determined.

Red—Picture is not sharp enough for an acceptable 4 x 6-inch (10 x 15 cm) print.

White—Printability is still being determined.

4

Doing more with your camera



Using the menu button



You can change settings to get the best results from your camera:

- 1 Press the Menu button.
- 2 Press $\blacktriangle/\blacktriangledown$ to highlight a setting, then press OK.
- 3 Choose an option, then press OK.
- 4 Press the Menu button to exit.

NOTE: Some settings remain until you change them; others, until you turn the Mode dial or turn off the camera. Some modes offer limited settings.

Press Menu, $\blacktriangle/\blacktriangledown$, and OK to access settings	Options
Self-timer	10 seconds —so you have time to get into the scene. 2 seconds —for a steady, auto-shutter release on a tripod. Off 2-shot —one picture is taken after a 10-second delay. A second picture is taken 8 seconds later.
Burst See page 32 .	On or Off
Exposure Bracketing Determine the best exposure level for your conditions based on your evaluation of 3 pictures.	Off +/- 0.5 +/- 1.0 The camera takes 3 pictures: + (plus), 0, and - (minus) exposure.

Press Menu,  ,  , and OK to access settings	Options
<p>Exposure Compensation Control how much light enters the camera.</p>	<p>-2.0 to +2.0 (in 0.5 increments)</p>
<p>Picture Size Choose a picture resolution. For recommended print sizes, visit www.kodak.com/go/printsizes</p>	<p>7.1 MP (default)—pictures are highest resolution and largest file size 6.1 MP (3:2)—for printing on an EasyShare printer dock 5.0 MP—pictures are medium resolution and file size 3.1 MP—pictures are smaller resolution and file size 2.2 MP (3:2)—for printing on an EasyShare printer dock 2.1 MP (16:9)—HDTV format 1.2 MP—for emailing, Internet, screen display, or for conserving space</p>
<p>White Balance Choose your lighting condition.</p>	<p>Auto (default)—automatically corrects white balance. Ideal for general picture taking. Daylight—for pictures in natural lighting. Tungsten—corrects the orange cast of household light bulbs. Ideal for indoor pictures under tungsten or halogen lighting without flash. Fluorescent—corrects the green cast of fluorescent lighting. Ideal for indoor pictures under fluorescent lighting without flash.</p>
<p>ISO Speed Control the camera's sensitivity to light.</p>	<p>Choose a lower ISO setting in brightly lit scenes; use a higher ISO for low-light scenes. Choose Auto (default), 80, 100, 200, 400, 800 (800 available only for smallest picture size setting). NOTE: ISO returns to Auto when the camera is set to Portrait, Digital Image Stabilization, Night Portrait, SCN, or Sports mode, and during Long Time Exposure. Unavailable in Video mode.</p>

Press Menu,  /  , and OK to access settings	Options
<p>Focus Zone Select a large or concentrated area of focus.</p>	<p>Multi-zone (default)—evaluates 3 zones to give an even picture focus. Ideal for general picture taking.</p> <p>Center-zone—evaluates the small area centered in the LCD. Ideal when precise focus of a specific area in the picture is needed.</p> <p>NOTE: For the best pictures, the camera is set to Multi-zone when in Landscape mode.</p>
<p>Color Mode Choose color tones.</p>	<p>Color</p> <p>Black & White</p> <p>Sepia—for pictures with a reddish-brown, antique look.</p> <p>NOTE: EasyShare software also lets you change a color picture to black-and-white or sepia.</p> <p>Unavailable in Video mode.</p>
<p>Long Time Exposure Choose how long the shutter stays open.</p>	<p>0.5–4.0 seconds</p>
<p>Set Album Choose Album names.</p>	<p>On or Off</p> <p>Pre-select album names before you take pictures or videos. Then, all the pictures or videos you take are tagged with those album names. See page 22.</p>
<p>Image Storage Choose a storage location for pictures/videos.</p>	<p>Auto (default)—the camera uses the card if one is in the camera. If not, the camera uses internal memory.</p> <p>Internal Memory—the camera uses internal memory, even if a card is installed.</p> <p>NOTE: If you fill up your card while taking pictures, your camera's memory plus feature prompts you to switch to internal memory, if space is available. Memory plus is unavailable in Video mode.</p>

Press Menu, ▲/▼, and OK to access settings	Options
Video Size	640 x 480 320 x 240 Available only in Video mode.
Setup Menu Choose additional settings.	See Using the setup menu on page 29 .

Using the setup menu



Use Setup to customize your camera settings.

- 1 Press the Menu button.
- 2 Press ▲/▼ to highlight Setup, then press OK.
- 3 Press ▲/▼ to highlight the setting you wish to change, then press OK.
- 4 Choose an option, then press OK.
- 5 Press the Menu button to exit.



NOTE: These settings remain until you change them.

Press Menu, ▲/▼ to highlight Setup, then OK to access settings	Options
Return to previous menu.	
Camera Sounds Choose sound effects.	Theme —applies the same sound effect set to all functions. Individual —choose a sound effect for each function.
Sound Volume	Off Low (default) Medium High

Press Menu, ▲/▼ to highlight Setup, then OK to access settings	Options
<p>Auto Power Off Choose inactivity time until camera turns off.</p>	<p>10 minutes 5 minutes 3 minutes (default) 1 minute</p>
<p>Date & Time</p>	<p>See page 3.</p>
<p>Video Out Choose the regional setting that lets you connect the camera to a television or other external device.</p>	<p>NTSC (default)—used in North America and Japan; most common format. PAL—used in Europe and China.</p>
<p>Red-eye Pre-flash Choose if the Red-eye flash fires automatically before a picture is taken. NOTE: The camera automatically corrects red-eye, when the Red-eye Pre-flash is set to Off.</p>	<p>On Off (default)</p>
<p>Date Stamp Imprint the date on pictures.</p>	<p>Choose a date option, or turn off the feature. (Default is off.)</p>
<p>Video Date Display Display Date/Time at the start of video playback.</p>	<p>On (default)—choose from date formats. Off</p>
<p>Blur Warning Display the image sharpness warning icon during quickview and review.</p>	<p>On (default) Off (See page 25.)</p>
<p>Language</p>	<p>See page 3.</p>

Press Menu,  /  to highlight Setup, then OK to access settings	Options
<p>Format</p> <p> CAUTION: Formatting deletes all pictures/videos, including those that are protected. Removing a card during formatting may damage the card.</p>	<p>Memory Card—deletes everything on the card; formats the card.</p> <p>Cancel—exits without making a change.</p> <p>Internal Memory—deletes everything in internal memory including email addresses, album names, and favorites; formats the internal memory.</p>
<p>About</p> <p>View camera information.</p>	

Using exposure compensation to adjust brightness

In Auto, you can adjust exposure compensation to make your pictures darker or lighter. Press  to decrease exposure compensation, and  to increase exposure compensation.

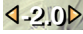
The exposure compensation level is shown on the LCD  and the LCD gets dimmer or brighter.

Using burst

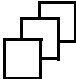
Option	Description	Purpose
 Burst	Camera takes up to 3 pictures (1.9 per second) while the Shutter button is pressed.  The first 3 pictures are saved.	Capture an expected event. Example: A person swinging a golf club.

- 1 Press the Menu button.
- 2 Press $\blacktriangle/\blacktriangledown$ to highlight Burst, then press OK.
- 3 Press $\blacktriangle/\blacktriangledown$ to highlight On, then press OK.
- 4 Press the Shutter button **halfway** to focus and set exposure.
- 5 Press the Shutter button **completely down and hold it** to take pictures.

The camera stops taking pictures when you release the Shutter button, when the pictures are taken, or when there is no more storage space.

NOTE: During quickview, you can delete all pictures in the burst series. To delete selectively, do so in Review (see [page 13](#)).

5

Transferring and printing pictures

Installing the software

- 1 Close all open software applications before starting the installation.

NOTE: If running Windows OS and installing EasyShare software from the Kodak Web site, do not close the WinZip application. If prompted, allow EasyShare software to access the Internet.

- 2 Place the Kodak EasyShare software CD into the CD-ROM drive.

- 3 Load the software:

Windows OS—if the install window does not appear, choose Run from the Start menu and type **d:\setup.exe** where **d** is the drive letter that contains the CD.

Mac OS X—double-click the CD icon on the desktop, then click the Install icon.

- 4 Follow the on-screen instructions to install the software.

NOTE: When prompted, register your camera and software. Registering lets you sign up for information that keeps your system up-to-date. To register later, visit www.kodak.com/go/register.

- 5 If prompted, restart the computer.

For information on the software applications included on the Kodak EasyShare software CD, see Help in EasyShare software.

Transferring pictures with the USB cable

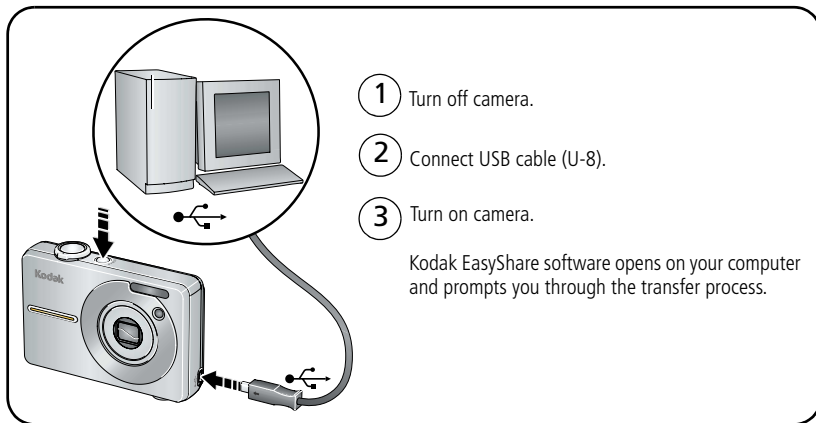

NOTE: Visit www.kodak.com/go/howto for an online tutorial on connecting.

Also available for transferring

You can also use these Kodak products to transfer your pictures/videos.

- Kodak EasyShare camera dock, Kodak EasyShare printer dock (see [page 35](#))
- Kodak multi-card reader, Kodak SD multimedia card reader-writer

Purchase these and other accessories at a dealer of Kodak products or www.kodak.com/go/c763accessories.

Printing pictures

Printing with a Kodak EasyShare printer dock

Dock your camera to the Kodak EasyShare printer dock and print directly—with or without a computer. Purchase this and other accessories at a dealer of Kodak products or visit www.kodak.com/go/c763accessories.

Direct printing with a PictBridge enabled printer

Your camera is compatible with PictBridge technology, so you can print directly to PictBridge enabled printers. You need:

- Camera with fully charged batteries
- PictBridge enabled printer
- USB cable (may be sold separately)

Connecting the camera to a PictBridge enabled printer

- 1 Turn off the camera and printer.
- 2 Connect the appropriate USB cable from the camera to the printer. (See your printer user guide or visit www.kodak.com/go/c763accessories.)

Printing from a PictBridge enabled printer

- 1 Turn on the printer. Turn on the camera.

The PictBridge logo is displayed, followed by the current picture and menu. (If no pictures are found, a message is displayed.) If the menu interface turns off, press any button to redisplay it.

- 2 Press **▲/▼** to choose a printing option, then press OK.

Current Picture	Press ◀/▶ to choose a picture. Choose the number of copies.
Tagged Pictures	If your printer is capable, print pictures that you tagged for printing and choose a print size.
Index Print	Print thumbnails of all pictures. This option requires one or more sheets of paper. If the printer is capable, choose a print size.
All Pictures	Print all pictures in internal memory, on a card, or in Favorites. Choose the number of copies.
Image Storage	Access internal memory, a card, or Favorites.

NOTE: During direct printing, pictures are not permanently transferred or saved to the computer or printer.

Disconnecting the camera from a PictBridge enabled printer

- 1 Turn off the camera and printer.
- 2 Disconnect the USB cable from the camera and the printer.

Using a printer that is not PictBridge enabled

For details on printing pictures from your computer, click the Help button in EasyShare software.

Ordering prints online

Kodak EasyShare Gallery (www.kodakgallery.com) is one of the many online print services offered in the Kodak EasyShare software. You can easily:

- Upload your pictures.
- Edit, enhance, and add borders to your pictures.
- Store pictures, and share them with family and friends.
- Order high-quality prints, photo greeting cards, frames, and albums—and have them delivered to your door.

Printing from an optional SD/MMC card

- Automatically print tagged pictures when you insert your card into a printer with an SD/MMC card slot. See your printer user's guide for details.
- Make prints at an SD/MMC card-capable Kodak picture maker/picture kiosk. (Contact a location before visiting. See www.kodak.com/go/picturemaker.)
- Take the card to your local photo retailer for professional printing.

Dock compatibility for your camera

To see which EasyShare printer docks are compatible with your camera, visit www.kodak.com/go/dockcompatibility.

Purchase camera docks, printer docks, and other accessories at a dealer of Kodak products or www.kodak.com/go/c763accessories.

6

Troubleshooting

For step-by-step product support, visit www.kodak.com/go/c763support and select Interactive Troubleshooting & Repairs.

Camera

Status	Solution
The camera does not work.	<ul style="list-style-type: none">■ Turn on the camera (page 2).■ Install new batteries (page 2) or charge rechargeable batteries.■ Turn camera off, then back on.

Camera/computer communications

Status	Solution
The computer does not communicate with the camera.	<ul style="list-style-type: none">■ Visit www.kodak.com/go/c763support.■ Turn on the camera (page 2).■ Install new batteries (page 2) or charge rechargeable batteries.■ Connect cable to camera and computer port (page 34).■ Install the software (page 33).■ Disconnect the USB cable. Close all software applications. Re-install the software (page 33).■ Disconnect camera from the computer. Close all software applications, reconnect camera.
Cannot transfer pictures. (The Add New Hardware Wizard cannot locate drivers.)	<ul style="list-style-type: none">■ Disconnect the USB cable. (If using camera dock or printer dock, disconnect cable and remove camera from dock). Close all open applications. Re-install the software (page 33).■ Disconnect the USB cable. Close all open applications. Re-install the software (page 33).

LCD screen messages

Status	Solution
No images to display	■ Change image storage location setting (page 26).
Memory card requires formatting	■ Insert a new card (page 4) or format the card (page 29). Caution: Formatting deletes all pictures/videos, including protected files.
Memory card cannot be read (Please format memory card or insert another card)	
Only one USB connection allowed. Disconnect cable or rem. (remove) camera from dock.	■ Unplug the USB cable from the camera.
Internal memory requires formatting	■ Format the internal memory (page 29). Caution: Formatting deletes all pictures/videos, including protected files.
Internal memory cannot be read (Please format internal memory)	
No memory card (Files not copied)	■ Insert a card (page 4).
Not enough space to copy files (Files not copied)	■ Delete pictures from the image storage location you are copying to (page 13), or insert a new card (page 4).
Memory card is locked (Insert new memory card)	■ Insert a new card (page 4), move the switch on the card to unlock the card, or change the image storage location to internal memory (page 26).
Read-only memory card. Remove write protection to capture or write to card.	
Memory card is unusable (Insert new memory card)	■ Insert a new card (page 4) or format the card (page 29). Caution: Formatting deletes all pictures/videos, including protected files.
Date and time have been reset	■ Reset the clock (page 3).

Status	Solution
No address book on camera (Connect with computer to import address book)	■ Create and copy address book from computer. See the Kodak EasyShare software Help.
No album names on camera (Connect with computer to import album names)	■ Create and copy album names from computer. See the Kodak EasyShare software Help.
High camera temperature. (Camera will be turned off.)	■ Leave the camera off until it's cool to the touch, then turn it back on. If the message reappears, visit www.kodak.com/go/c763support and select Interactive Troubleshooting & Repairs.
Unrecognized file format	■ Transfer the picture to the computer (page 34), or delete it (page 13).
Camera error #XXXX. See user's guide.	Turn camera off, then back on. If the message reappears, visit www.kodak.com/go/c763support and select Interactive Troubleshooting & Repairs.

7

Getting help

Camera

Email, write, or phone Kodak	www.kodak.com/go/contact
Get support for your product (FAQs, troubleshooting information, arrange for repairs, etc.)	www.kodak.com/go/c763support
Purchase camera accessories (camera docks, printer docks, lenses, cards, etc.)	www.kodak.com/go/c763accessories
Download the latest camera firmware and software	www.kodak.com/go/c763downloads
See online demonstrations of your camera	www.kodak.com/go/howto

Software

Get information on EasyShare software	www.kodak.com/go/easysharesw (or click the Help button in EasyShare software)
Get help with the Windows operating system and working with digital pictures	www.kodak.com/go/pcbasics

Other

Get support for cameras, software, accessories, more	www.kodak.com/go/support
Get information on Kodak EasyShare printer docks	www.kodak.com/go/printerdocks
Get information on Kodak inkjet products	www.kodak.com/go/inkjet
Optimize your printer for truer, more vibrant colors	www.kodak.com/go/onetouch
Register your camera	www.kodak.com/go/register

NOTE: If you have questions concerning this product, you may speak with Kodak customer support.

Australia	1800 267 588	Netherlands	020 346 9372
Austria	0179 567 357	New Zealand	0800 880 120
Belgium	02 713 14 45	Norway	23 16 21 33
Brazil	0800 891 42 13	Philippines	1 800 1 888 9600
Canada	1 800 465 6325	Poland	00800 4411625
China	800 820 6027	Portugal	021 415 4125
Denmark	3 848 71 30	Russia	8 495 929 9166
Ireland	01 407 3054	Singapore	800 6363 036
Finland	0800 1 17056	Spain	91 749 76 53
France	01 55 1740 77	Sweden	08 587 704 21
Germany	069 5007 0035	Switzerland	01 838 53 51
Greece	00800 44140775	Taiwan	0800 096 868
Hong Kong	800 901 514	Thailand	001 800 631 0017
India	91 80 41374555 (toll free 000800 440 1227)	Turkey	00800 448827073
Italy	02 696 33452	United Kingdom	0870 243 0270
Japan	03 5540 9002	United States	1 800 235 6325
Korea	080 708 5600	International Toll Line	+44 131 458 6714
		International Toll Fax	+44 131 458 6962

8

Appendix

Camera specifications

For more specifications, visit www.kodak.com/go/c763support.

CCD (charge-coupled device)	
CCD	1/2.5 in. CCD, 4:3 aspect ratio
Output image size	7.1MP: 3072 x 2304 pixels 6.1MP (3:2): 3072 x 2048 pixels 5.0 MP: 2592 x 1944 pixels 3.1 MP: 2048 x 1536 pixels 2.2 MP: (3:2) 1800 x 1200 pixels 2.1 MP: (16:9) 1920 x 1080 pixels 1.2 MP: 1280 x 960 pixels
Displays	
Color display	6.35 cm (2.5 in) color hybrid LCD, 154 K pixels
Preview	Frame rate: 20 fps
Lens	
Taking lens	3X optical zoom lens f/2.8–f/4.9 35 mm–105 mm (35 mm equivalent)
Lens barrier	Automatic built-in
Digital zoom	5.0X continuous with 0.2X increments Not supported for video capture

Focus system	TTL-AF, selectable: Multi-zone AF, Center-zone AF. Working range: 0.5 m (19.6 in.)–infinity @ wide 0.5 m (19.6 in.)–infinity @ telephoto 0.1–0.5 m (3.9–19.6 in.) @ wide close-up/macro 0.4–0.8 m (15.7–31.5 in.) @ telephoto close-up/macro
Exposure	
Exposure metering	TTL-AE; Center-weighted
Exposure compensation	+/-2.0 EV with 0.5 EV step
Exposure bracketing	Yes
Long time exposure	Yes
Shutter speed	Mechanical shutter with CCD electrical Auto: 4–1/1400 sec.
ISO speed	Auto: 80–200 Selectable: 80, 100, 200, 400, 800 (800 available only for smallest picture size setting)
Flash	
Electronic flash	Guide no. 5.6 Auto flash with pre-flash Working range at ISO 200: 0.5–2.3 m (1.6–7.5 ft) @ Wide; 0.8–1.4 m (2.6–4.6 ft) @ Tele
Flash modes	Auto, Fill, Red-eye, Off
Capture	
Capture modes	Auto, Digital Image Stabilization, Portrait, Night Portrait, Sports, Landscape, Close-up, SCN (Scene Modes), Video
Burst	Maximum 3 pictures; 1.9 pictures per second
Video capture	VGA (640 x 480) @ 15 fps QVGA (320 x 240) @ 30 fps

Image file format	Still: EXIF 2.21 (JPEG compression); file organization: DCF Video: QuickTime (CODEC MotionJPEG)
Image storage	Optional SD/MMC Card  . (The SD logo is a trademark of the SD Card Association.)
Internal storage capacity	32 MB internal memory/26 MB available for image storage (1 MB equals one million bytes)
Review	
Quickview	Yes
Video output	NTSC or PAL selectable
Power	
Kodak Li-Ion rechargeable digital camera battery KLIC-7005; Kodak 5V AC adapter	
Communication with computer	
USB 2.0 full speed via USB cable model U-8, EasyShare camera dock, or printer dock	
Other features	
PictBridge support	Yes
Self Timer	2 seconds, 10 seconds, or 2-shot
White balance	Auto, Daylight, Tungsten, Fluorescent
Auto power off	Selectable 1, 3, 5, 10 minutes
Color modes	Color, Black & White, Sepia
Date stamp	None, YYYY/MM/DD, MM/DD/YYYY, DD/MM/YYYY
Tripod mount	1/4 inch
Operating temperature	32-104°F (0-40°C)
Size	90 mm (3.5 in.) x 60 mm (2.4 in.) x 23 mm (0.9 in.) @ power off
Weight	130 g (4.6 oz.) without battery or card

Care and maintenance

- If you suspect water has gotten inside the camera, remove the battery and card. Allow all components to air-dry for at least 24 hours before using the camera.
- Blow gently on the lens or LCD to remove dust and dirt. Wipe gently with a soft, lint-free cloth or an untreated lens-cleaning tissue. Do not use cleaning solutions unless designed specifically for camera lenses. Do not allow chemicals, such as suntan lotion, to contact painted surfaces.
- Service agreements may be available in your country. Contact a dealer of Kodak products for more information.
- For digital camera disposal or recycling information, contact your local authorities. In the US, visit the Electronics Industry Alliance Web site at www.eiae.org or www.kodak.com/go/c763support

Important safety instructions

CAUTION:

Do not disassemble this product; there are no user-serviceable parts inside. Refer servicing to qualified service personnel. Kodak AC adapters and battery chargers are intended for indoor use only. The use of controls, adjustments, or procedures other than those specified herein may result in exposure to shock and/or electrical or mechanical hazards. If the LCD breaks, do not touch the glass or liquid. Contact Kodak customer support.

- The use of an accessory that is not recommended by Kodak may cause fire, electric shock, or injury. For approved accessories, visit www.kodak.com/go/accessories.
- Use only a USB-certified computer equipped with a current-limiting motherboard. Contact your computer manufacturer if you have questions.
- If using this product in an airplane, observe all instructions of the airline.
- When removing the battery, allow it to cool; it may be hot.
- Follow all warnings and instructions supplied by the battery manufacturer.

- Use only batteries approved for this product to avoid risk of explosion.
- Keep batteries out of the reach of children.
- Do not allow batteries to touch metal objects, including coins. Otherwise, a battery may short circuit, discharge energy, become hot, or leak.
- Do not disassemble, install backward, or expose batteries to liquid, moisture, fire, or extreme temperature.
- Remove the battery when the product is stored for an extended period of time. In the unlikely event that battery fluid leaks inside the product, contact Kodak customer support.
- In the unlikely event that battery fluid leaks onto your skin, wash immediately with water and contact your local health provider. For additional health-related information, contact your local Kodak customer support.
- Dispose of batteries according to local and national regulations. Visit www.kodak.com/go/kes.
- Do not charge non-rechargeable batteries.
For more information on batteries, visit www.kodak.com/go/batterytupes.

Upgrading your software and firmware

Download the latest versions of the software included on the Kodak EasyShare software CD and the camera firmware (the software that runs on the camera). See www.kodak.com/go/c763downloads.

Storage capacities

The LCD displays the approximate number of pictures (or minutes/seconds of video) remaining. For average SD card capacities, visit www.kodak.com/go/memory (and click the SD card). Actual storage capacity varies depending on subject composition, card size, and other factors. You may be able to store more or fewer pictures and videos. Favorites take up additional space in internal memory.

Battery life

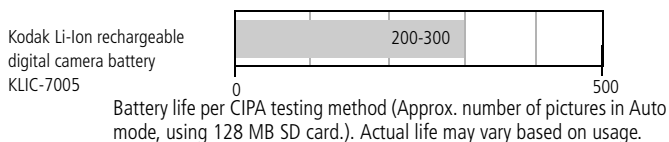

For acceptable battery life, and to make sure your camera operates dependably, use the batteries listed.

Extending battery life

- Use power-saving features ([see page 30](#)). Limit activities such as reviewing pictures/videos on the LCD.
- Dirt on the battery contacts can affect battery life. Wipe the contacts with a clean, dry cloth before loading the battery in the camera.
- Battery performance is reduced at temperatures below 41° F (5° C). When using your camera in cold weather, carry spare batteries and keep them warm. Do not discard cold batteries that do not work; when they return to room temperature, they may be usable.

Limited warranty

Kodak warrants Kodak consumer electronic products and accessories ("Products"), excluding batteries, to be free from malfunctions and defects in both materials and workmanship for one year from the date of purchase. Retain the original dated sales receipt. Proof of the date of purchase will be required with any request for warranty repair.

Limited warranty coverage

Warranty service is only available from within the country where the Products were originally purchased. You may be required to ship Products, at your expense, to the authorized service facility for the country where the Products were purchased.

Kodak will repair or replace Products if they fail to function properly during the warranty period, subject to any conditions and/or limitations stated herein. Warranty service will include all labor as well as any necessary adjustments and/or replacement parts. If Kodak is unable to repair or replace a Product, Kodak will, at its option, refund the purchase price paid for the Product provided the Product has been returned to Kodak along with proof of the purchase price paid. Repair, replacement, or refund of the purchase price are the sole remedies under the warranty. If replacement parts are used in making repairs, those parts may be remanufactured, or may contain remanufactured materials. If it is necessary to replace the entire Product, it may be replaced with a remanufactured Product. Remanufactured Products, parts and materials are warranted for the remaining warranty term of the original Product, or 90 days after the date of repair or replacement, whichever is longer.

Limitations

This warranty does not cover circumstances beyond Kodak's control.

This warranty does not apply when failure is due to shipping damage, accident, alteration, modification, unauthorized service, misuse, abuse, use with incompatible accessories or attachments (such as third party ink or ink tanks), failure to follow Kodak's operation, maintenance or repacking instructions, failure to use items supplied by Kodak (such as adapters and cables), or claims made after the duration of this warranty. Kodak makes no other express or implied warranty for this product, and disclaims the implied warranties of merchantability and fitness for a particular purpose. In the event that the exclusion of any implied warranty is ineffective under the law, the duration of the implied warranty will be one year from the purchase date or such longer period as required by law. The option of repair, replacement, or refund is Kodak's only obligation. Kodak will not be responsible for any special, consequential or incidental damages resulting from the sale, purchase, or use of this product regardless of the cause. Liability for any special, consequential or incidental damages (including but not limited to loss of revenue or profit, downtime costs, loss of the use of the equipment, cost of substitute equipment, facilities or services, or claims of your customers for such damages resulting from the purchase, use, or failure of the Product), regardless of cause or for breach of any written or implied warranty is expressly disclaimed.

Your rights

Some states or jurisdictions do not allow exclusion or limitation of incidental or consequential damages, so the above limitation or exclusion may not apply to you. Some states or jurisdictions do not allow limitations on how long an implied warranty lasts, so the above limitation may not apply to you. This warranty gives you specific rights, and you may have other rights which vary from state to state or by jurisdiction.

Outside the United States and Canada

In countries other than the United States and Canada, the terms and conditions of this warranty may be different. Unless a specific Kodak warranty is communicated to the purchaser in writing by a Kodak company, no warranty or liability exists beyond any minimum requirements imposed by law, even though defect, damage, or loss may be by negligence or other act.

Regulatory compliance

FCC compliance and advisory



Kodak EasyShare C763 zoom digital camera

This equipment has been tested and found to comply with the limits for a Class B digital device, pursuant to Part 15 of the FCC Rules. These limits are designed to provide reasonable protection against harmful interference in a residential installation.

This equipment generates, uses, and can radiate radio frequency energy and, if not installed or used in accordance with the instructions, may cause harmful interference to radio communications. However, there is no guarantee that interference will not occur in a particular installation.

If this equipment does cause harmful interference to radio or television reception, which can be determined by turning the equipment off and on, the user is encouraged to try to correct the interference by one or more of the following measures: 1) reorient or relocate the receiving antenna; 2) increase the separation between the equipment and the receiver; 3) connect the equipment to an outlet on a circuit different from that to which the receiver is connected; 4) consult the dealer or an experienced radio/TV technician for additional suggestions.

Any changes or modifications not expressly approved by the party responsible for compliance could void the user's authority to operate the equipment. Where shielded interface cables have been provided with the product or specified additional components or accessories elsewhere defined to be used with the installation of the product, they must be used in order to ensure compliance with FCC regulation.

Australian C-Tick



Canadian DOC statement

DOC Class B Compliance—This Class B digital apparatus complies with Canadian ICES-003.

Observation des normes-Classe B—Cet appareil numérique de la classe B est conforme à la norme NMB-003 du Canada.

Waste Electrical and Electronic Equipment labeling



In the European Union, do not discard this product as unsorted municipal waste. Contact your local authorities or go to www.kodak.com/go/recycle for recycling program information.

Korean Class B ITE

이 기기는 가정용으로 전자파적합등록을 한 기기로서 주거지역에서는 물론 모든 지역에서 사용할 수 있습니다.

VCCI Class B ITE

この装置は、情報処理装置等電波障害自主規制協議会（VCCI）の基準に基づいてクラスB情報技術装置です。この装置は、家庭環境で使用することを目的としていますが、この装置が携帯電話やテレビジョン受信機に近接して使用されると、電波障害を引き起こすことがあります。
取扱説明書に従って正しい取り扱いをして下さい。

China RoHS

环保使用期限 (EPUP)

在中国大陆, 该值表示产品中存在的任何危险物质不得释放, 以免危及人身健康、财产或环境的时间期限(以年计)。该值根据操作说明中所规定的产品正常使用而定。

有毒有害物质或元素名称及含量标识表

部件名称	有毒有害物质或元素					
	铅	汞	镉	六价铬	多溴联苯	多溴二苯醚
数码相机电路板元件	×	○	○	○	○	○
电池电路板元件	×	○	○	○	○	○
电池充电器电路板元件	×	○	○	○	○	○
交流变压器电路板元件	×	○	○	○	○	○

○: 表示该有毒有害物质在该部件所有均质材料中的含量均在SJ/T 11363-2006规定的限量要求以下。

×: 表示该有毒有害物质至少在该部件的某一均质材料中的含量超出SJ/T 11363-2006规定的限量要求。



USB 数据线



锂电池

Russian GOST-R



Eastman Kodak Company
Rochester, NY 14650

A10-40

Фотокамера изготовлена в Китае; остальные элементы - в соответствии с маркировкой.

Index

A

- about picture, video, 24
- about this camera, 31
- accessories, 34
 - battery, 48
 - buying, 41
 - printer dock, 35
 - SD/MMC card, 4
- album
 - set, 28
 - tagging pictures, 22
- appendix, 43
- auto, 8
 - flash, 10
 - focus framing marks, 6

B

- backlight, 9
- battery
 - expected life, 48
 - extending life, 48
 - loading, 2
 - type, 45
- battery compartment, ii
- beach, 9
- blur, 25
- blur warning, 30
- burst, using, 32
- button
 - delete, 6
 - flash, 10
 - shutter, i

zoom, 7

C

- cable
 - USB, 34
- camera screen
 - error messages, 39
- camera sounds, 29
- care and maintenance, 46
- children, 9
- clock, setting, 3
- close-up, 8
- color mode, 28
- compatibility, dock, 37
- copy pictures
 - card to memory, 23
 - memory to card, 23
 - to computer, 33
- cropping pictures, 14
- customer support, 42
- customizing camera settings, 29

D

- date setting, 3
- date stamp, 30
- DC-in, ii
- deleting
 - during quickview, 6
 - pictures, videos, 13
- digital image stabilization, 8
- digital zoom, using, 7
- displaying slide show, 14

disposal, recycling, 46, 52
dock
 compatibility, 37
 connector, ii
 printer, 35
doing more with your camera, 26
download pictures, 33

E
emailing pictures, videos, 17
error messages, 39
expected battery life, 48
exposure
 bracketing, 26
 compensation, 27, 31
 long time, 28

F
favorites
 removing, 20
 settings, 20
 tagging, 19
fill flash, 10
fireworks, 9
firmware, upgrading, 47
flash
 fill, 10
 off, 10
 red-eye, 10
 settings, 10
focus
 framing marks, 6
 zone, 28
format, 31

G
guidelines, battery, 48

H
help, 38

I
icons
 blur, 25
 mode dial, 8
 picture-taking, 11
 reviewing pictures, 24
image storage, 28
information
 about pictures, videos, 24
installing
 battery, 2
 SD/MMC card, 4
 software, 33
internal memory
 storage capacity, 47
interval, slide show, 15

K
Kodak EasyShare software
 installing, 33
 upgrading, 47

L
landscape, 8
LCD, ii
 reviewing pictures, 12
 reviewing videos, 12
lens
 cleaning lens, 46

loading

- battery, 2
- SD/MMC card, 4
- software, 33

long time exposure, 28

loop, slide show, 15

M

Mac OS, installing software, 33

magnify a picture, 12

maintenance, camera, 46

memory

- inserting card, 4

mode dial, 8

modes

- auto, 8
 - backlight, 9
 - beach, 9
 - children, 9
 - close-up, 8
 - digital image stabilization, 8
 - fireworks, 9
 - landscape, 8
 - night portrait, 8
 - party, 9
 - portrait, 8
 - SCN, 8
 - self-portrait, 9
 - snow, 9
 - sports, 8
- multi-up, 16

N

night portrait, 8

O

online prints, ordering, 37

optical zoom, 7

P

party, 9

PictBridge enabled printer, 35

picture size, 27

pictures

- copying, 23
- cropping, 14
- deleting, 13
- emailing tagged, 17
- printing, 36
- protecting, 13
- reviewing, 12
- tagging, 22
- taking, modes, 8
- transfer, 33

playing a video, 12

portrait, 8

power

- camera, 2

printer dock, 35

printing

- from a card, 37
- from computer, 36
- order online, 37
- PictBridge technology, 35
- tagged pictures, 37
- with EasyShare printer dock, 35

problem-solving, 38

protecting pictures, videos, 13

Q

quickview
using, 6

R

ready light, ii
recycling, disposal, 46, 52
red-eye, flash, 10
regulatory information, 50
removing favorites, 20
repair, 41
return, 29
reviewing pictures/videos
as you take them, 6
LCD, 12
slide show, 14
running slide show, 14

S

safety, 46
scene (SCN) modes, 9
SCN, 8
SD/MMC card
inserting, 4
printing from, 37
storage capacities, 47
self-portrait, 9
self-timer, 26
self-timer/video light, i
service and support telephone
numbers, 42
setting
about, 31
album, 28

blur warning, 30
camera sounds, 29
color mode, 28
date and time, 3
date stamp, 30
exposure bracketing, 26
exposure compensation, 27
flash, 10
focus zone, 28
image storage, 28
long time exposure, 28
picture size, 27
picture taking mode, 8
return, 29
self-timer, 26
sound volume, 29
video date display, 30
video out, 30
video size, 29
white balance, 27
setup menu, using, 29
shaking hand, 25
sharing pictures, videos, 16
shutter button, i
slide show
continuous loop, 15
interval, 15
running, 14
snow, 9
software
installing, 33
upgrading, 47
sound volume, 29
sounds, 29

specifications, camera, 43
sports, 8
status
 blur, 25
storage capacities, 47
strap, carry, 1
support, technical, 42

T

tagging
 favorites, 19
 for albums, 22
 for email, 17
 for print, 17
taking a picture, 5
taking a video, 5
telephone support, 42
time, setting, 3
tips
 battery guidelines, 48
 care & maintenance, 46
transferring pictures, videos, 33
trash can, deleting, 6
tripod socket, ii
troubleshooting, 38
 camera/computer
 communications, 38
 error messages, 39
turning camera on and off, 2

U

undelete, 13
undo, 13
upgrading software, firmware, 47

USB cable, 34

V

video
 copying, 23
 date display, 30
 out, 30
 playback, 12
 protecting, 13
 size, 29
 viewing, 12
videos
 deleting, 13
 emailing tagged, 17
 transfer, 33
viewing
 by multi-up, 16
 picture, after taking, 12
volume, 29

W

warranty, 48
WEEE, 52
white balance, 27
Windows OS, installing software, 33

Z

zoom
 digital, 7
 optical, 7